



*Radiologic Technology to the  
Mid-Atlantic since 1987*



Chesapeake Medical Systems, Inc.  
118 Cedar Street  
Cambridge, MD 21613  
ChesapeakeMed.com  
800-333-5643

# Window Frame Mounting Instructions

## Rough Opening:

- Glass Width + 1 ½"
- Glass Height + 1 ½"

## Wall Thickness:

- Minimum + 4 ¼"
- Maximum 6"

## Overall Dimensions:

- Glass Width + 4 ½"
- Glass Height + 4 ½"

## NOTES:

- (A) Unless otherwise stated, leaded view windows are measured by glass size.
- (B) Place leaded side of frame on leaded side of wall.
- (C) Fasten frame through jamb into studs.



*Radiologic Technology to the  
Mid-Atlantic since 1987*



Chesapeake Medical Systems, Inc.  
118 Cedar Street  
Cambridge, MD 21613  
ChesapeakeMed.com  
800-333-5643

## TELESCOPIC WALL VIEW FRAME

- 1) Set non-lead (A) side of frame into rough opening on operator's side of partition
- 2) Level frame with blocking and secure with screws (provided, see Diagram 1).
- 3) Slide lead (B) side of frame tightly against wall on X Ray side and into 'A'. Secure with screws provided as per diagram.
- 4) Set glass into frame. Use glazier's setting blocks along bottom (glass should NOT rest directly on frame).
- 5) Set removable stops with screws (provided). Use care and protective devices to prevent scratching glass.

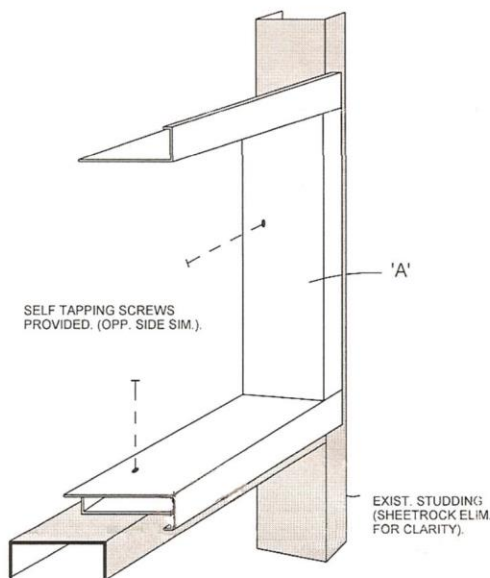

DIAGRAM 1

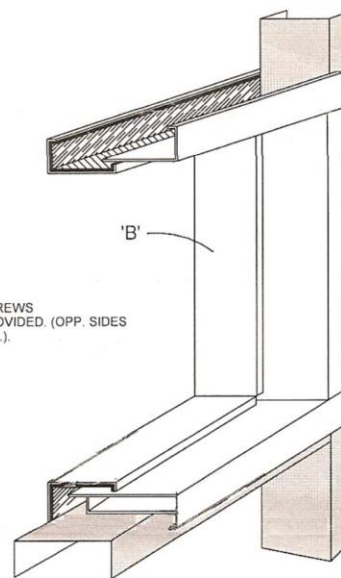

DIAGRAM 2

---

Notes:  
ROUGH OPENING IS 1-1/2" LARGER THAN GLASS SIZE  
(i.e. 24" x 36" GLASS SIZE = 25-1/2" x 37-1/2" ROUGH OPENING).